





Create Virtual Machine

Name and operating system

1

Please choose a descriptive name for the new virtual machine and select the type of operating system you intend to install on it. The name you choose will be used throughout VirtualBox to identify this machine.

Name:

Type:

Version:

64

64

It happens that I've started by Ubuntu 64-bit, but you can start with your Favorite Linux distribution. However, my articles will support only Ubuntu, Debian, CentOS, and OpenSuse 64-bit version. Note that CentOS would be Redhat under VirtualBox.

CCNA HUB

Hide Description

Next

Cancel



Create Virtual Machine

2 Memory size

Select the amount of memory (RAM) in megabytes to be allocated to the virtual machine.

The recommended memory size is **512 MB**.



Change the default from 512 to 1024 MB.

CCNA HUB

Next

Cancel



Create Virtual Machine

3 Hard drive

If you wish you can add a virtual hard drive to the new machine. You can either create a new hard drive file or select one from the list or from another location using the folder icon.

If you need a more complex storage set-up you can skip this step and make the changes to the machine settings once the machine is created.

The recommended size of the hard drive is **8.00 GB**.

- Do not add a virtual hard drive
- Create a virtual hard drive now
- Use an existing virtual hard drive file

isp-ccnahub-com-disk1.vmdk (Normal, 100.00 GB)

CCNA HUB

Create

Cancel

Create Virtual Hard Drive

4 Hard drive file type

Please choose the type of file that you would like to use for the new virtual hard drive. If you do not need to use it with other virtualization software you can leave this setting unchanged.

- VDI (VirtualBox Disk Image)
- VMDK (Virtual Machine Disk)
- VHD (Virtual Hard Disk)
- HDD (Parallels Hard Disk)
- QED (QEMU enhanced disk)
- QCOW (QEMU Copy-On-Write)

CCNA HUB

Hide Description

Next

Cancel



Create Virtual Hard Drive

5 Storage on physical hard drive

Please choose whether the new virtual hard drive file should grow as it is used (dynamically allocated) or if it should be created at its maximum size (fixed size).

A **dynamically allocated** hard drive file will only use space on your physical hard drive as it fills up (up to a maximum **fixed size**), although it will not shrink again automatically when space on it is freed.

A **fixed size** hard drive file may take longer to create on some systems but is often faster to use.

Dynamically allocated

Fixed size

CCNA HUB

Next

Cancel



Create Virtual Hard Drive

6 File location and size

Please type the name of the new folder in the text box below or click on the folder icon to select a different folder to create the file in.

Ubuntu 12.04 64-bit Template



Select the size of the virtual hard drive in megabytes. This size is the limit on the amount of file data that a virtual machine will be able to store on the hard drive.



At one point, you might need to reclaim free space at each VM, therefore, I don't recommend to have the main drive greater than 30 Giga. You can add extra drives later on at the Production or testing VMs.

At this point, this would be the last step before creation, change the HD size and hit the create button to create the VM. Next, we need to change some settings before Powering Up the VM to setup the OS.

CCNA HUB

Create

Cancel

7

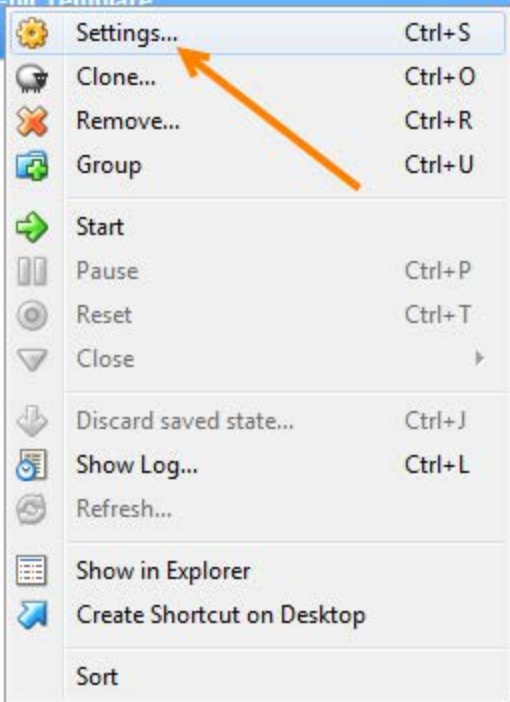

We need to go to the settings in order to select and unselect some settings, besides, to select the right IOS file to setup the OS later on..

- General
- System
- Display
- Storage
- Audio
- Network
- Serial Ports
- USB
- Shared Folders

Storage 8

Storage Tree

- Controller: IDE
 - Empty
- Controller: SATA
 - Ubuntu 12.04 64-bit Template....

Attributes

CD/DVD Drive: IDE Secondary Master

 Live CD/DVD

Information

Type: --

Size: --

Location: --

Attached To: --

Choose a virtual CD/DVD disk file...

Host Drive 'E:'

Host Drive 'F:'

Remove disk from virtual drive

Under **Storage** settings, select where it says "**Empty**" Number 2, then on the right side, hit the **Disc** number 3, another small dialog box will open, select "**Choose a Virtual CD/DVD disk**" number 4 to select your Linux ISO file. In my case, I am going to select the Ubuntu 12.04 ISO file.

OK

Cancel

Help

- General
- System
- Display
- Storage
- Audio**
- Network
- Serial Ports
- USB
- Shared Folders

2

Audio 9

Enable Audio

Host Audio Driver: Windows DirectSound

Audio Controller: ICH AC97

1

Since I am setting up a Server VM template, select the **Audio** under the Storage settings and uncheck the Box to disable the Audio.

Select a settings category from the list on the left-hand side and move the mouse over a settings item to get more information.



- General
- System
- Display
- Storage
- Audio
- Network**
- Serial Ports
- USB
- Shared Folders

Network 10

- Adapter 1
- Adapter 2
- Adapter 3
- Adapter 4

Enable Network Adapter

Attached to: Bridged Adapter

Name: Realtek RTL8723AE Wireless LAN 802.11n PCI-E NIC

▶ Advanced

1

2

3

After Audio settings would be the Network settings. Under **Attached to:** Select Bridged Adapter, then under **Name:** pick your LAN NIC or Wireless Interface.

Select a settings category from the list on the left-hand side and move the mouse over a settings item to get more information.



OK

Cancel

Help

- General
- System
- Display
- Storage
- Audio
- Network
- Serial Ports
- USB
- Shared Folders

USB 11

- Enable USB Controller
- Enable USB 2.0 (EHCI) Controller

USB Device Filters

Since I am setting up a Server VM, select **USB** settings and uncheck the 2nd Box to disable USB 2.0. Keep the first check box "**Enable USB Controller**" selected.

Press Ok Button below to apply your changes and close the Window. Next, would be to run the VM and install the OS, please follow the OS setup Article to continue. Thanks for following the Template VM Hardware Specs creation instructions.

Lists all USB filters of this machine. The checkbox to the left defines whether the particular filter is enabled or not. Use the context menu or buttons to the right to add or remove USB filters.

